



FIFTY FIVE

CREATIVE
HUB

IDEAS MADE **REAL.**

FIFTY FIVE

CREATIVE HUB

YOUR ALL-IN-ONE CREATIVE HUB

- Concept to distribution
- Studio to post-production
- Tailored solutions to fit your specific needs

We manage every detail so you can focus on bringing your vision to life.



BRANDS
CREATORS
PRODUCTION

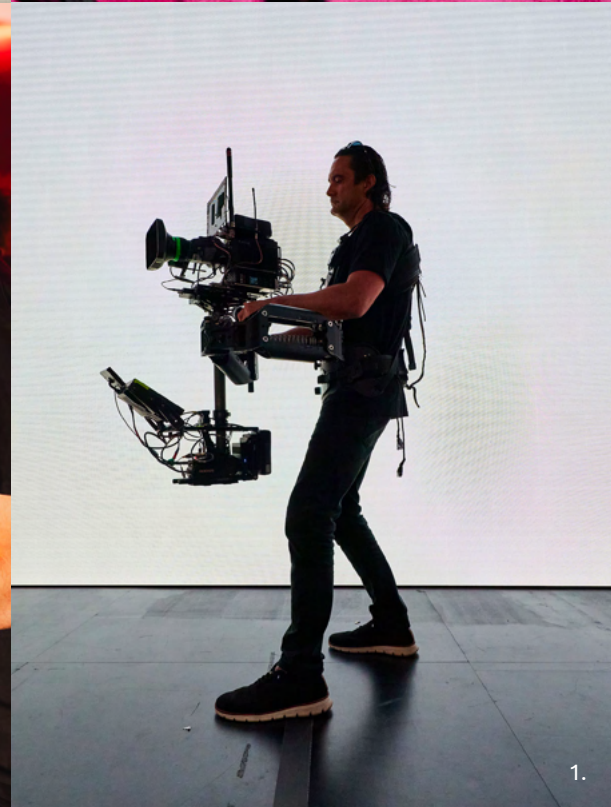



PRODUCTION

- 30,000 sq. ft. of **versatile studio** and control room space
- Fully equipped with **industry-leading gear**
- Efficient, ready-to-roll setups for fast production



POST-PRODUCTION

- End-to-end post services at the **highest industry standards**
- **Expert** editing, color grading, and distribution
- Polished, **platform-ready** content delivered on time



MUSIC

- **Custom** compositions, perfected through the final mix
- Sound design, immersive soundtracks, and **sonic branding**
- **Precision-crafted** audio to elevate your story



DISTRIBUTION

- **Seamless** delivery to any audience, across any platform
- **Live** streaming, broadcast, and syndication



CONTENT CREATOR SPACES

- Tailored, **versatile studios** perfect for everything from interviews to video podcasts
- **Fully customizable layouts** and setups to align with your specific vision

► PRODUCTION TURNKEY SETUP

Big. Flexible. Ready.

Our studios combine space and versatility, equipped with top-tier switchers, graphics, audio, and transmission technology. You can count on our expert crew or bring your own team, we adapt every setup to deliver seamless, standout results.



EQUIPMENT

GREEN SCREEN STUDIOS

BEST IN-CLASS CREW

► POST-PRODUCTION

HIGHEST INDUSTRY STANDARDS

Every detail, from the frame to the sound and effects is perfected.
Our expert team crafts polished content, ready for any platform.

50 SUITES
AVAILABLE



EDITING &
COLOR CORRECTION



GRAPHIC &
MOTION DESIGN

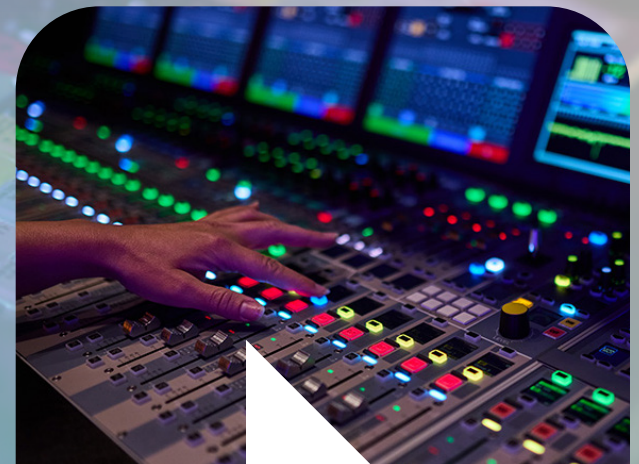

SOUND
DESIGN

► MUSIC

Collaborate with award-winning composers, engineers, and producers to create original music, immersive mixes, and powerful sonic branding to elevate your project's narrative.

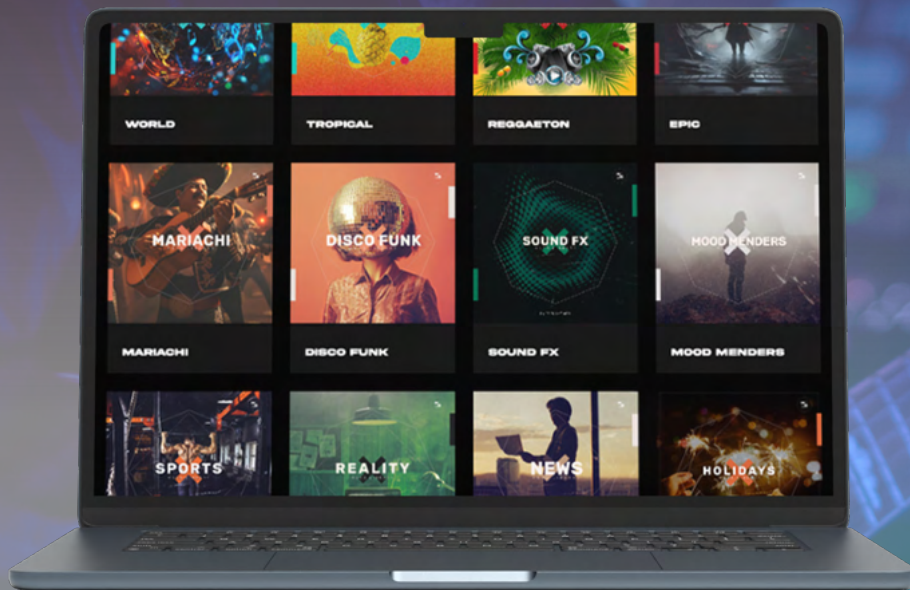

MUSIC LIBRARY

Explore the **M&SD Music Library**, a curated catalog of high-impact tracks for film, TV, digital, and live content. We craft audio that connects and stays with your audience.

ORIGINAL MUSIC

SONIC BRANDING

SCORING

SOUND DESIGN

► DISTRIBUTION

SEAMLESS DELIVERY

From live transmission to broadcast, streaming, and syndication, we ensure your content reaches every audience with precision. Our team handles the technical details, delivering your work clearly, quickly, and without compromise.

LINEAR

SATELLITE

FIBER

IP



CONTENT CREATOR SPACES

SETS READY-TO-SHOOT

Modular, customizable sets with premium props, visuals, and production tools designed to meet the demands of top brands and creative producers.



PODCAST SETS

A complete production solution, helping brands and creators deliver standout audio and video content that converts on every platform.



ADDITIONAL SPACES & SERVICES

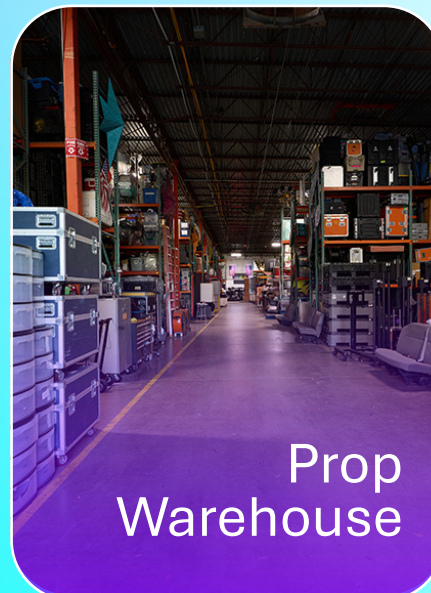



STUDIO A

SIZE

7,200 sq. ft.

DIMENSIONS

Unobstructed 105'-0" x 85'-0"

GRID HEIGHT

31'-0"

CEILING HEIGHT

37'-0"

GREEN ROOMS

Available

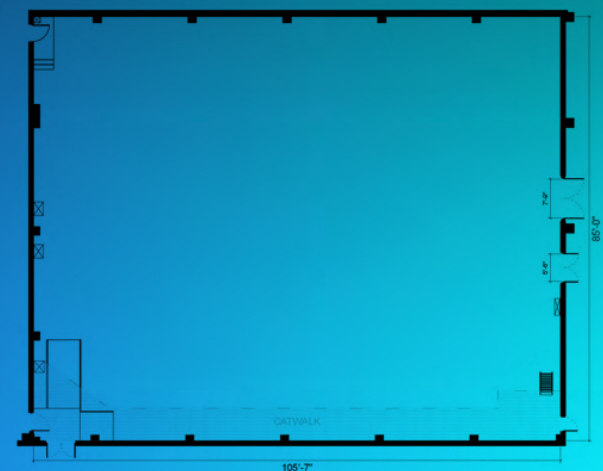

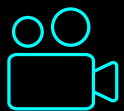

7

Sony HDC-3500 cameras



CAMERA CONFIGURATION & SUPPORT

- 2 Fujinon 23x + viewfinder
- Fujinon 18x wide-angle + viewfinder
- Fujinon 77x studio setup (viewfinder, zoom and focus)
- 2 Fujinon 27x studio setup (viewfinder, zoom and focus)
- Fujinon 16x + viewfinder
- 1 Jimmy Jib Triangle
- 3 Vinten pedestals
- 3 Vinten tripods
- 16 Clear-Com FreeSpeak II wireless systems



AUDIO



- 42 Shure ADX1 lavalier belt packs
- 15 Shure P10R+ IFB belt packs



LIGHTING



- 2 GrandMA3 lighting consoles





STUDIO B

SIZE

4,000 sq. ft.

DIMENSIONS

Unobstructed 50'-2" x 80'-0"

GRID HEIGHT

19'

CEILING HEIGHT

30'-0"

GREEN ROOMS

Available

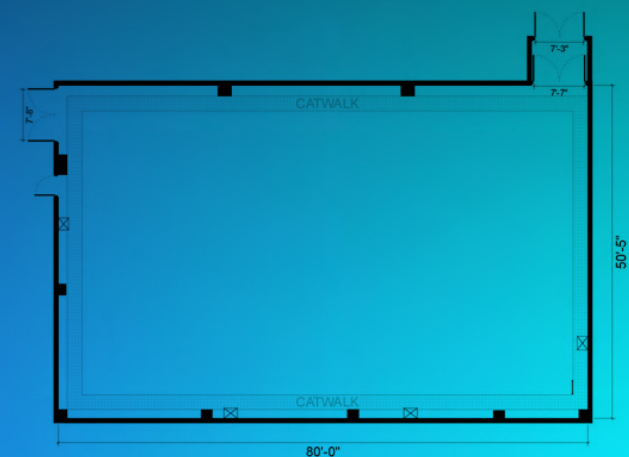

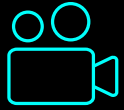

6 Ikegami 79EXII cameras



CAMERA CONFIGURATION & SUPPORT

- **27x** Fujinon (studio setup prompter, viewfinder, zoom and focus)
- **13x** Fujinon + viewfinder
- **16x** Fujinon + viewfinder
- **13x** Fujinon + prompter monitor
- **18x** Fujinon + prompter monitor
- **13x** Fujinon
- **2** Vinten pedestals
- **2** Vinten tripods
- **1** Jimmy Jib Triangle
- **1** Steadicam



AUDIO



- **12** Shure ADX1 lavalier belt packs
- **7** Shure P10R+ IFB belt packs
- **4** Shure ADX2 Beta 87 handheld mics
- **10** Clear-Com FreeSpeak II wireless systems





STUDIO C

SIZE

4,860 sq. ft.

DIMENSIONS

Unobstructed 81'-2" x 60'-0"

GRID HEIGHT

25"

CEILING HEIGHT

37'-6"

GREEN ROOMS

Available

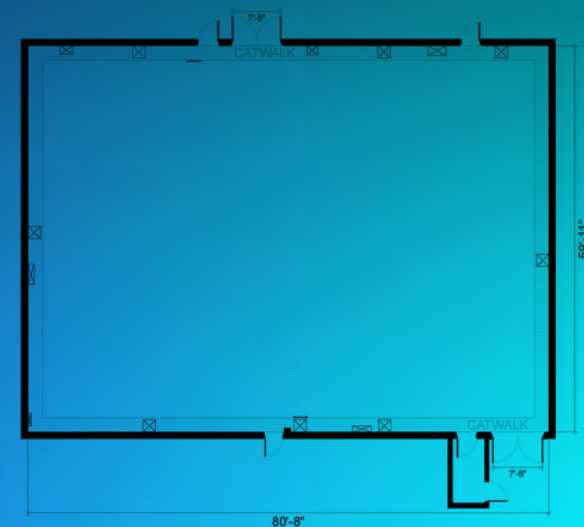

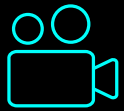

8

Sony HDC-3200 cameras



CAMERA CONFIGURATION & SUPPORT

- 5 Fujinon 27x (studio setup prompter, viewfinder, zoom and focus)
- Fujinon 18x +studio viewfinder
- Fujinon 13x + prompter (jib)
- Fujinon 13x + viewfinder (Steadicam)
- 1 Jimmy Jib Triangle
- 3 Vinten pedestals
- 3 Vinten tripods
- 1 Steadicam



AUDIO



- 12 Shure ADX1 lavalier belt packs
- 8 Shure P10R+ IFB belt packs
- 7 Shure ADX2 Beta 87 handheld mics
- 10 Clear-Com FreeSpeak II wireless systems



ADDITIONAL GEAR



- 10 Sony LMD-A170 17" broadcast monitors





STUDIO E

SIZE	15,500 sq. ft.
DIMENSIONS	Unobstructed 100'-0" x 150'-0"
GRID HEIGHT	Variable-Motorized Grid System
CEILING HEIGHT	41'-0"
GREEN ROOMS	Available

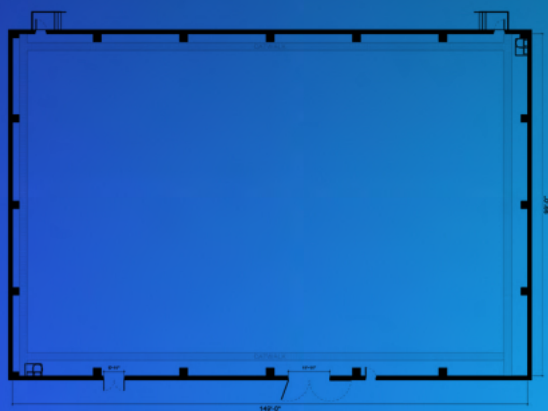

STUDIO F

SIZE	5,000 sq. ft.
DIMENSIONS	Unobstructed 58'-0" x 86'-4"
GRID HEIGHT	17'-10"
CEILING HEIGHT	37'-6"
GREEN ROOMS	Available

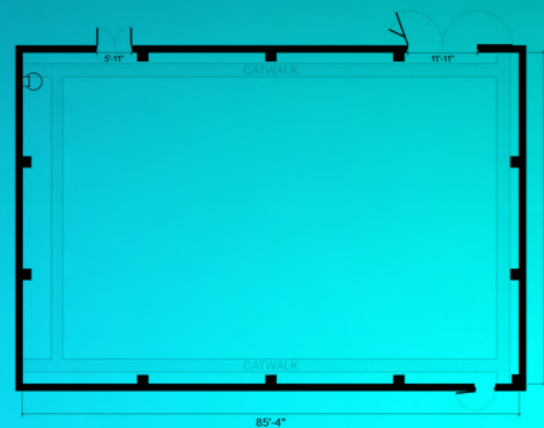

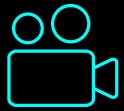

12

Sony HDC-4300
cameras

1

Sony HDC-P1
camera



AUDIO



- 16 Sennheiser 6000 handheld microphones (black)
- 17 Shure ADX1 lavalier belt packs
- 17 Shure P10R IEM/IFB (in-ear monitoring / interruptible feedback)
- 8 Aviom A360 personal mixers IEM systems
- 1 Aviom D-800 IEM system
- 29 FreeSpeak II beltpack comms systems
- 9 Sennheiser ME66 shot-gun microphone
- 2 GENELEC 1031 Bi-amp monitor speakers
- 1 DIGICO SD-10 FOH audio mixing desk
- 1 DIGICO SD-9 monitor mixing desk
- 1 DIGICO SD rack DIGICO I/O rack
- 2 D&B D-6 power amps
- 4 D&B D-12 power amps
- 4 D&B D-80 power amps
- 8 Studio technologies 371A Dante intercom belt pack
- 5 Tempest Clear-Com comm system





05 PRODUCTION CONTROL ROOMS

Our **state-of-the-art** control rooms power flawless productions, perfect for **live broadcasts, hybrid events, and multicam shoots**. They deliver broadcast-level quality with ease, speed, and reliability.

PCR 4

- Grass Valley Kayenne K Frame (5 ME, 16 Aux, 4 different programs outs with audio)
- RTS system for each position
- 11 work positions in PCR
- Calrec Apollo
- 1 360 Audio player
- 2 - 6 channel EVS with configurable inputs and output channels
- Kaleido Multiviewer
- 6 Vizrt graphics channels

PCR 5/6

- Grass Valley Kayenne K Frame (5 ME, 16 Aux, 4 different programs outs with audio)
- Calrec Artemis
- 1 360 Audio player
- 9 work positions in PCR
- RTS system for each position
- 2 - 6 channel EVS with configurable inputs and output channels
- Kaleido Multiviewer
- 6 Vizrt graphics channels

PCR 7

- Grass Valley Kayenne K Frame (5 ME, 16 Aux, 4 different programs outs with audio)
- Calrec Apollo
- 1 360 Audio player
- 11 work positions in PCR
- RTS system for each position
- 2 - 6 channel EVS with configurable inputs and output channels
- Kaleido Multiviewer
- 6 Vizrt graphics channels

PCR 8

- Grass Valley Kayenne K Frame (5 ME, 16 Aux, 4 different programs outs with audio)
- Calrec Artemis
- 2 360 Audio player
- 11 work positions in PCR
- RTS system for each position
- 2 - 6 channel EVS with configurable inputs and output channels
- Kaleido Multiviewer
- 6 Vizrt graphics channels



MOBILE

01 MOBILE PRODUCTION UNIT

High Definition Double Expando - (Native 1080i)

POWER REQUIREMENTS

- 3-phase, 208 volts 200 amps per leg
- Split 400-amp service preferred (environmental, tech.).

DIMENSIONS

- Expanded: 56' L x 13'6" H x 15'2" W (without tractor)



MOBILE PRODUCTION UNIT – APPENDIX

PRODUCTION & EFFECTS

- Grass Valley Kayenne SXP K-Frame Production Switcher
- 96 inputs, 48 outputs
- 5 mix / effects
- 6 full function keyers per ME or 8 keyers (shared)
- Double Take – Split ME
- FlexiKey – Programmable clean feeds8
- 8 floating iDPMs
- 2D DPM with perspective on all keyers
- 30 floating chroma keyers
- Image storer / movies RAM record
- ClipsStore II – 4-channel player (fill & matte)
- Match def / Set def
- 32 RGB color correctors in MEs
- Evertz 288 x 288 HD router

AUDIO

- Calrec Artemis Digital Console (2022)
- Calrec Hydra 48mic/line-16line-32AES
- LCD Bar Graph & VU Metering
- 64 Dual layer faders
- MADI (4 X 64 in & 4 x 64 out)
- Genelec 5.1 Audio Monitoring
- Dolby E System
- Eventide H8000 Effects Processor
- Eventide H3000S Harmonizer
- 2 TC electronics M2000
- 1 Sony D7 delay unit
- 2 Digicart/E audio recorder w/Zip drive
- 1 CD player

GRAPHICS

- ChyronHego Mosaic Duo (2 channels)
- Vizrt Trio (2 channels)

CAMERAS & SUPPORT (WIRED FOR 16 CAMERAS)

- 11 Ikegami 79EC HD Native 1080i CMOS cameras
- SMPTE and triax adapters available
- LCD viewfinders
- 7 Vinten pan heads, tripods, and dollies; Matthews tripods and dollies
- 7 Vinten Vision pan heads and tripods
- 3 studio build-up kits for handheld cameras

MICROPHONES

- 5 Sennheiser HMD-25 announcer headsets
- 5 Daltech talkback boxes
- 9 Sennheiser MKH 416 shotgun mics
- 1 Sennheiser ME66
- 1 Sennheiser ME80
- 2 Sennheiser MKH 816 shotgun mics
- 3 EV 635 hand mics
- Shure SM57, SM58, SM77 hand mics
- Sennheiser MD421, MD441 hand mics

COMMUNICATIONS

- RTS Adam 128 x128 matrix with ADAM trunking
- 16 IFB channels
- 14 KP-32 intercom stations (4 throw down)
- 6 KP 12 intercom stations (2 throw down)
- 14 RTS IFB beltpacks
- 26 BP-325 dual-listen beltpacks
- 25 single-muff headsets
- 20 double-muff headsets
- 15 lightweight headsets
- 2 TIF and 2 Gentner hybrids
- 1 PBX phone system, dual-mode IP & POTS
- 7 two-way radios with two base stations

CABLES

- 4000' DT 12 Audio Mult
- Single Audio (various lengths)
- 8300'SMPTE Fiber (various lengths)
- 8000'Mini Triax (various lengths)
- Coax Video (various lengths)
- 5 Pair & 10 Pair Coax Mults (various lengths)
- Fiber Package On request

EXTERNAL MONITORS

- 5 Ikegami 9" HD monitors
- 2 Ikegami 19" HD monitors
- 9 Ikegami 9" SD monitors
- 3 Sony 14" SD monitors

LENSES

- 4 Fujinon 88 x 8.8 lenses
- 3 Fujinon 23 x 7.6 handheld lenses
- 2 Fujinon 27 x 6.5 lenses
- 5 Fujinon 14 x 4.5 wide-angle lenses

PLAYBACKS

- Two 8-channel EVS
- IPDirector
- Xfile 3

VIRTUAL MONITOR WALL

- 15 40" 16:9 NEC monitors
- Evertz VIPX routing and multi-image display system

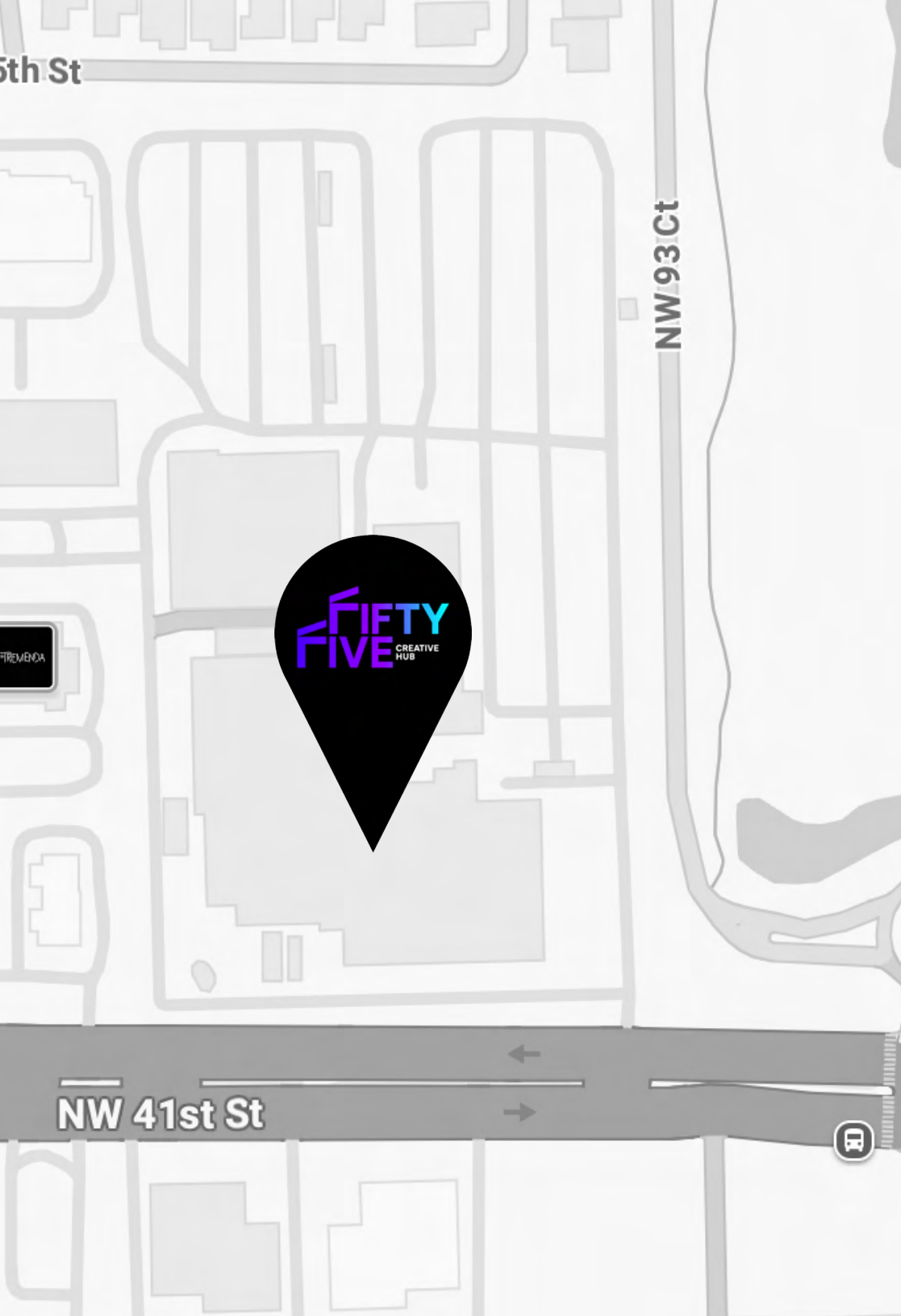

CONTACT US

EMAIL:

contact@fiftyfivecreativehub.com

WEBSITE:

fiftyfivecreativehub.com

PHONE:

(305) 979-6432

ADDRESS:

9405 NW 41st St
Miami, FL 33178

15 minutes from Miami International Airport



FIFTYFIVE

CREATIVE HUB